



**Porta a saloon**  
apertura ad ante battenti verso l'interno e verso l'esterno.

**Paroi de douche à deux panneaux à battants**  
ouverture vers l'extérieur et l'intérieur.

**Saloon door**  
shower enclosure with inward and outward pivot doors.

**Puerta abatible tipo saloon**  
con apertura con hojas abatibles hacia el interior y el exterior.

**Pendeltür**  
Schwingtüröffnung nach außen und nach innen.

**Saloondeur**  
douchedeur met twee zowel naar binnen als naar buiten openzwaaiende panelen.

**Распашная дверь типа салун**  
распашные створки открываются вовнутрь и наружу.



H 195 cm. - V 6 mm.

## Porta a saloon

Paroi de douche a deux panneaux à battant



Saloon door

Puerta abatible tipo saloon

Pendeltür

Saloondeur

Распашная дверь типа салун

Z [cm]	Cod.	A [cm]	B [cm]	C [cm]	 [dm³]	 [kg]	 [n°]
67-71	B0930	//	27,8	52	114	24	1

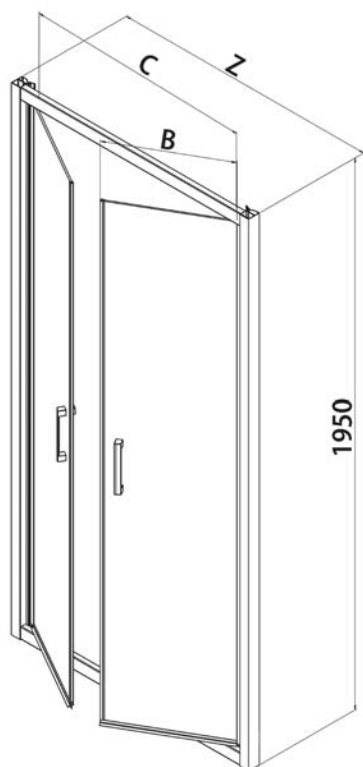

**160 mm**

Interasse maniglia  
Empattement de la poignée  
Handle wheelbase  
Distancia entre ejes de la manija  
Radstand handhaben  
Handvat wielbasis  
Колесная база ручки

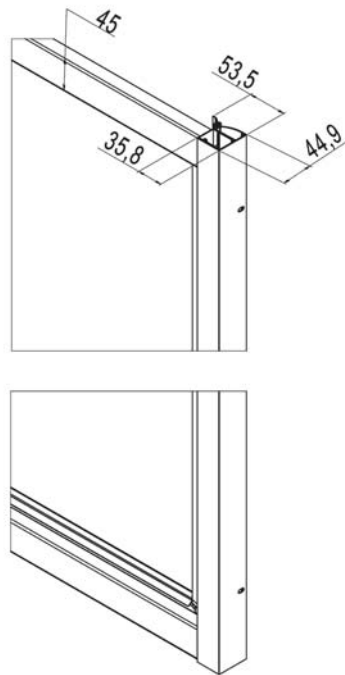
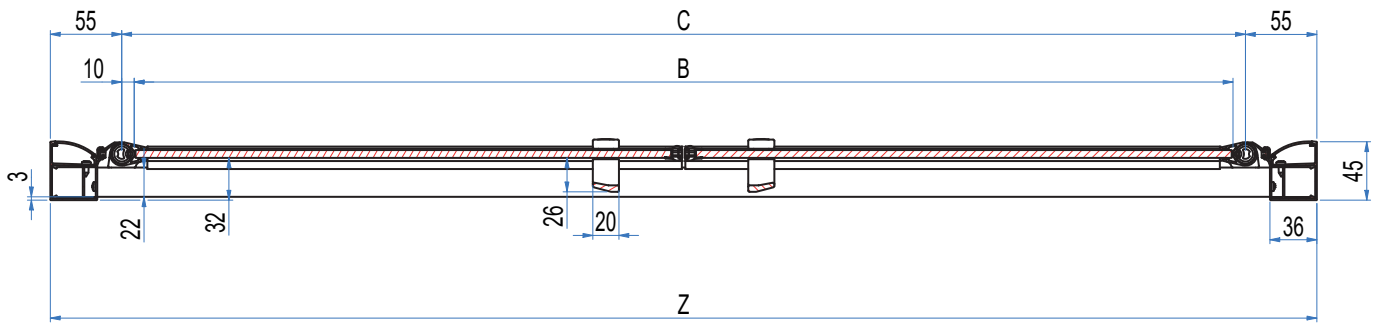

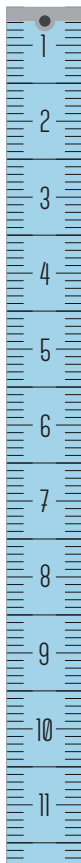

Prodotti Speciali - Produits Spéciaux - Special products - Productos Especiales - Sonderafertigungen - Maatwerk - Специальные Иродукты

MISURE LIMITE	Altezza max 200 cm.	//	Larghezza max 121 cm.	Larghezza min 50 cm.
MESURES LIMITES	Hauteur max 200 cm.	//	Largeur max 121 cm.	Largeur min 50 cm.
LIMITS OF MEASUREMENTS	Height max 200 cm.	//	Width max 121 cm.	Width min 50 cm.
MEDIDAS LIMITE	Altura max 200 cm.	//	Anchura max 121 cm.	Anchura min 50 cm.
GRENZMAßE	Höhe max 200 cm.	//	Breite max 121 cm.	Breite min 50 cm.
EXTREME MATEN	Hoogte max 200 cm.	//	Breedte max 121 cm.	Breedte min 50 cm.
ПРЕДЕЛЬНЫЕ РАЗМЕРЫ:	Макс. высота 200 см	//	Макс. ширина 121 см	Мин. ширина 50 см

	I								
	II								
	III								

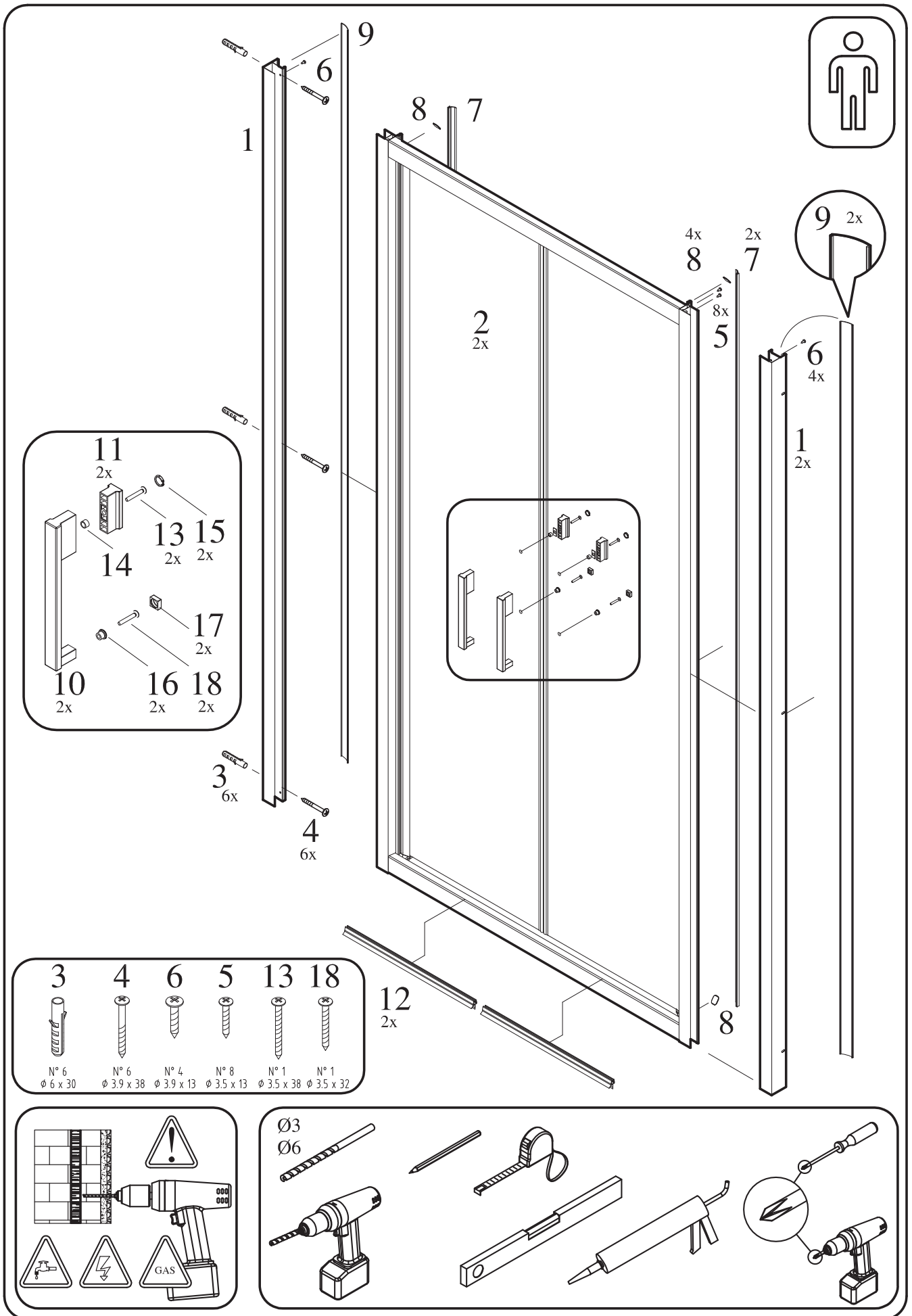

RIC2233  
2x

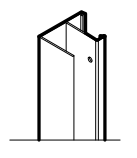

RIC1804  
4x  
8x  
4x  
4x

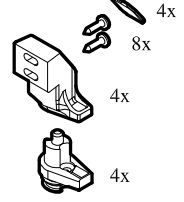

RIC2244  
RIC2245  
RIC2246  
RIC2247  
1x



RIC1620  
2x

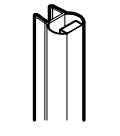

RIC2235  
2x

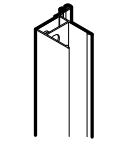

RIC1731  
2x

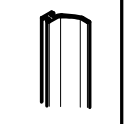

RIC1798  
2x

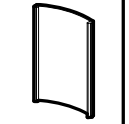

RIC1799  
6x



RIC1808  
2x

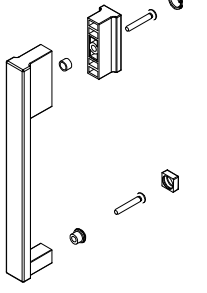
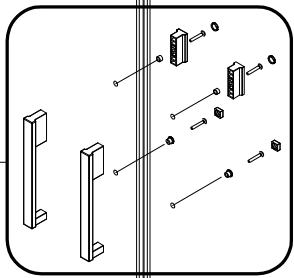

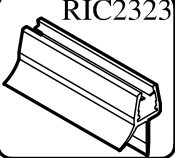
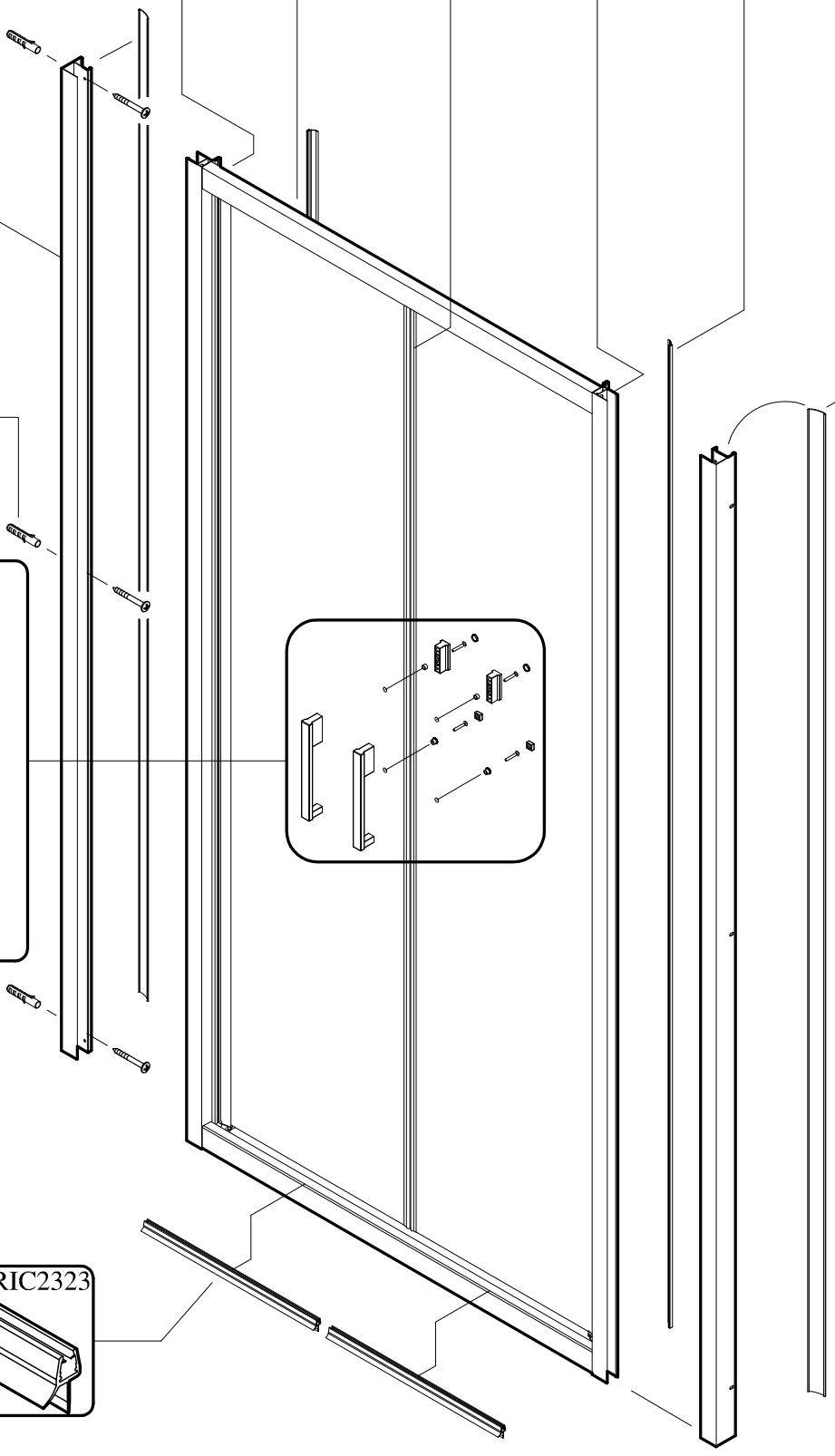

RIC2323

*RIC1731*

2x

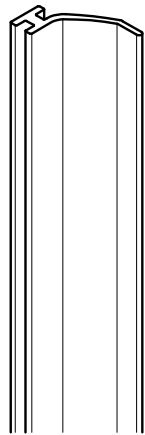

*RIC1798*

2x

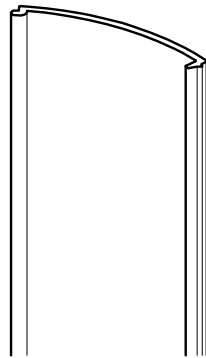

*RIC2233*

2x

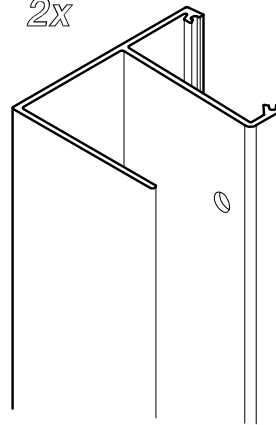

*RIC2235*

2x

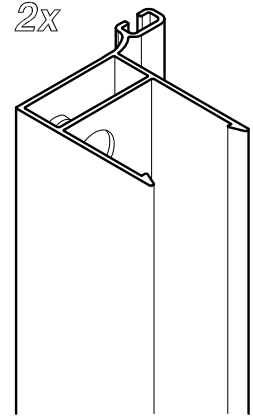

*RIC1799*



6x

*RIC1620*

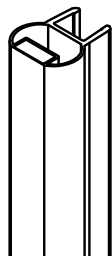

2x

*RIC2244* - B0930

*RIC2245* - B0932

*RIC2246* - B0933

*RIC2247* - B0934

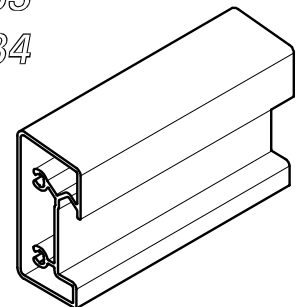

1x

*RIC1808*

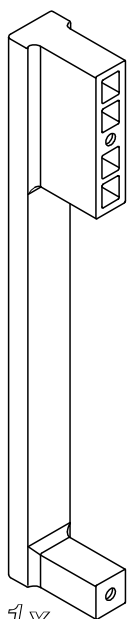

1x

1x

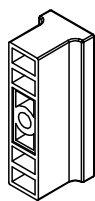

1x



1x



1x



1x



1x



1x



*RIC1804*

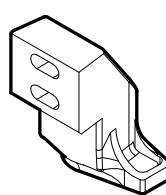

2x

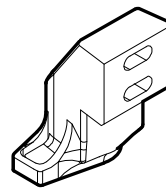

2x

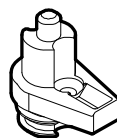

4x



4x



8x

*RIC2323*

2x

