

Rev. Dianflex: 04/2025

ART. 877	SPECIFICATIONS		APPLICATION	TECHNICAL NOTES
	Series	877	Assembly in rigid pipe system	Item designed, manufactured and tested in accordance to: EN 1074:2004/11:2006 and EN 1074-3:2004 Manufacturing process managed in accordance to: EN ISO 9001
	Thread ends	Male-Male-Female UNI ISO 228/1	Nominal pressure (PN) in bar: 10	
3-way washing machine ball valve, Size 1/2"x1/2"x3/4".	Orifice	8 mm	KV: flowrate coefficient m <sup>3</sup> /h	All valves comply with directive 2014/68/UE and are 100% tested with electrically controlled pneumatic seal test.
	Actuator	90° rotation with mechanical stop	Direction of flow: as desired	
	Operator	Alluminum handle	Temperature range: -20 °C / +90°C Use: Water	2 YEARS warranty. Manufactured in brass alloy compliant with EN 12165-CW617N-DW.

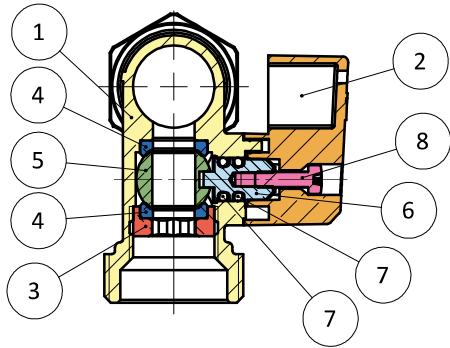

N°	Descrizione	Description	Materials	Treatment	Q.ty
1	Corpo	Body	CW617N	Chrome-Plated	1
2	Leva	Handle	ALUMINUM	Chrome-Plated	1
3	Ghiera	Compression ring	CW614N		1
4	Guarnizione sede sfera	Ball seal	PTFE		2
5	Sfera	Ball	CW617N	Ni+Cr	1
6	Perno	Stem	CW614N		1
7	O-Ring	O-Ring	NBR70sh		2
8	Vite	Screw	Fe	Zinc Plated	1

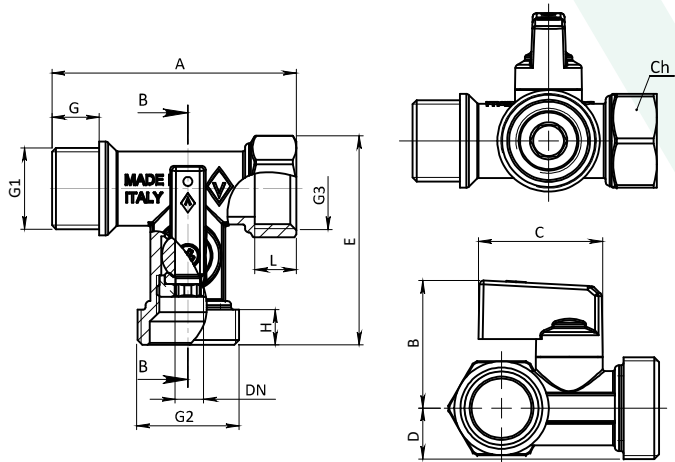

DN	G1	G2	G3	A	B	C	D	E	G	H	L	Ch	PN
8	1/2"	3/4"	1/2"	62	32.5	31.5	13	53.5	12	9	10.5	24	10

N° Disegno / Drawing Nr	Misure / Size		UFFICIO TECNICO
877	1/2"x1/2"x3/4"		