

## RACCORDO TERMINALE END FITTING

### Art.1879

#### Descrizione / Description

Raccordo terminale con attacco per connessioni 1/2"x16. Disponibile in ottone CW617N o in ottone anti-dezincificante CW602N.

End fitting for 1/2"x16 connections. Available made of CW617N brass or decinification resistant brass CW602N.



CODICE/Code	SIZE	Material
1440063	1/2"x16	CW617N

#### Caratteristiche Tecniche

Temperatura max di esercizio: 110°C  
Pressione max in ingresso: 10 bar  
Filettature: Femmina ISO 228

#### Technical Features

Maximum temperature: 110°C  
Maximum inlet pressure: 10 bar  
Threads: Female ISO 228

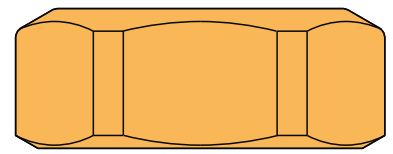
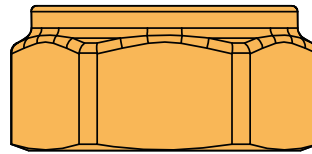

1/2"x15-1/2"x16

3/4"x18 (Eurocono)

#### Certificazioni Certifications

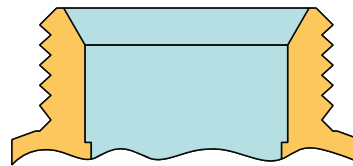

Descrizione	Materiale	Trattamento	Description	Material	Treatment
Corpo	Ottone CW617N - EN12164 Ottone CW602N - EN12164	-	Body	CW617N-EN12164 brass CW602N-EN12164 brass	-
Dado	Ottone CW617N - EN12165 Ottone CW602N - EN12165	-	Nut	CW617N-EN12164 brass CW602N-EN12164 brass	-
O-ring	Gomma etilele-propilene EPDM	-	O-ring	Ethylene-propylene rubber EPDM	-
Guarnizione	Fasit 202	-	Flat washer	Fasit 202	-